

Rewinding spool from bulk line

Replacement spools of cutting line are available from your BLACK+DECKER dealer. Packs containing 3 spools of cutting line are also available.

Alternatively, you can rewind the spool from a bulk supply.

Remove the empty spool from the trimmer as described below.

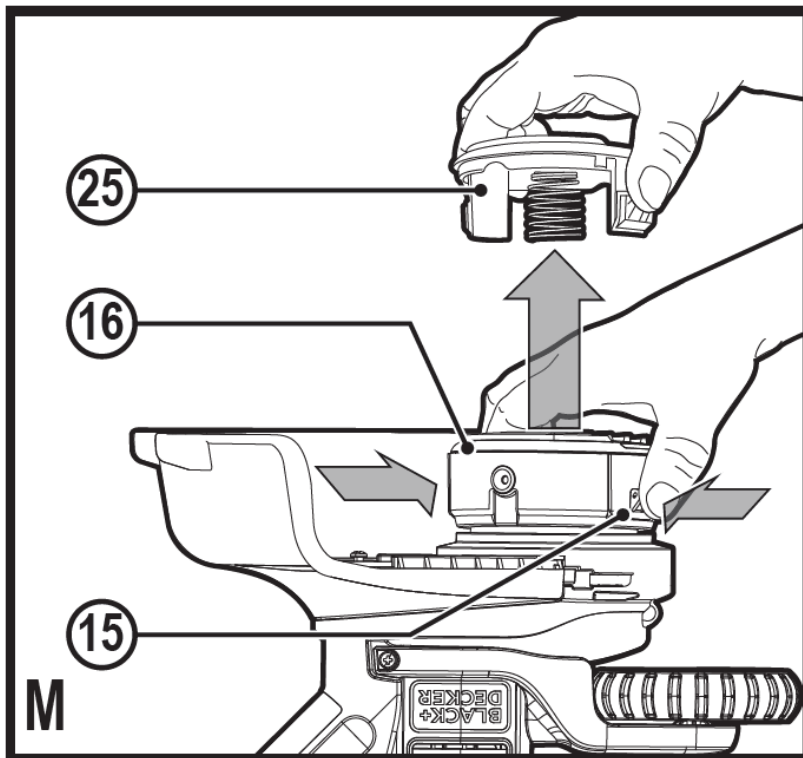

Depress the tabs (15) and remove the spool cap (25) from the spool housing (16) in the trimmer head (Fig. M).

Grasp empty spool with one hand and spool housing with other hand and pull spool out.

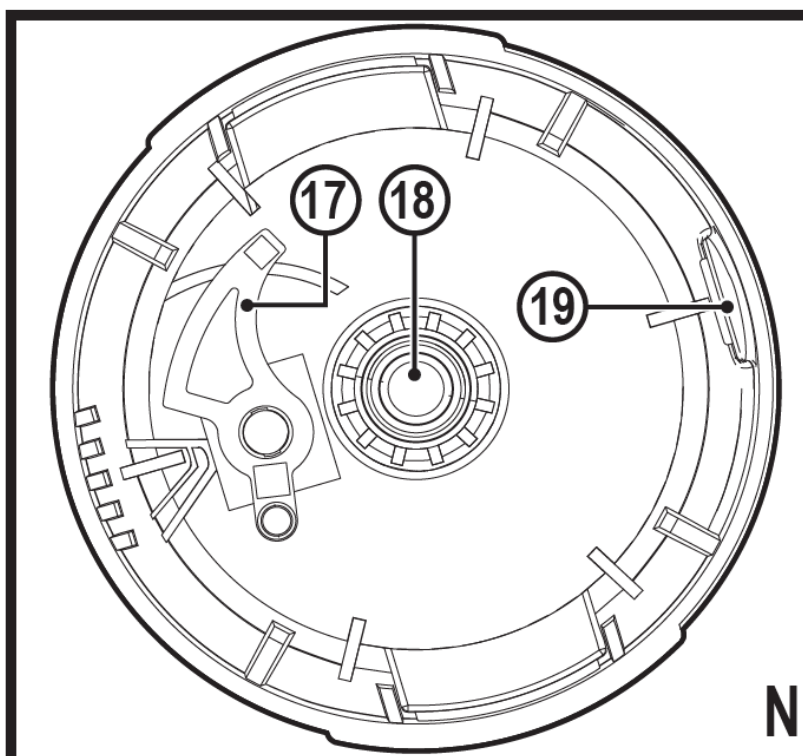

If lever (17) (Fig. N) in base of housing becomes dislodged, replace in correct position before inserting new spool into housing.

Remove any dirt and grass from the spool and housing.

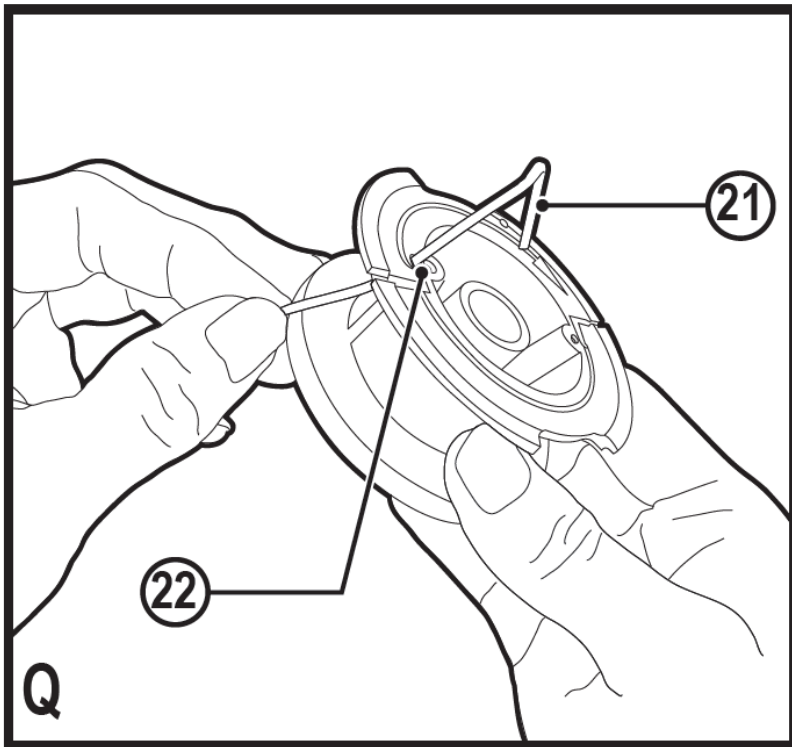

Remove any remaining cutting line from the spool.

Make a fold at the end of the cutting line at about 19mm (21). Feed the cutting line into one of the line anchoring slots (22) as shown in Fig. Q.

Note: Take care not to allow the line on the spool to unravel. Hold it firmly with one hand at all times

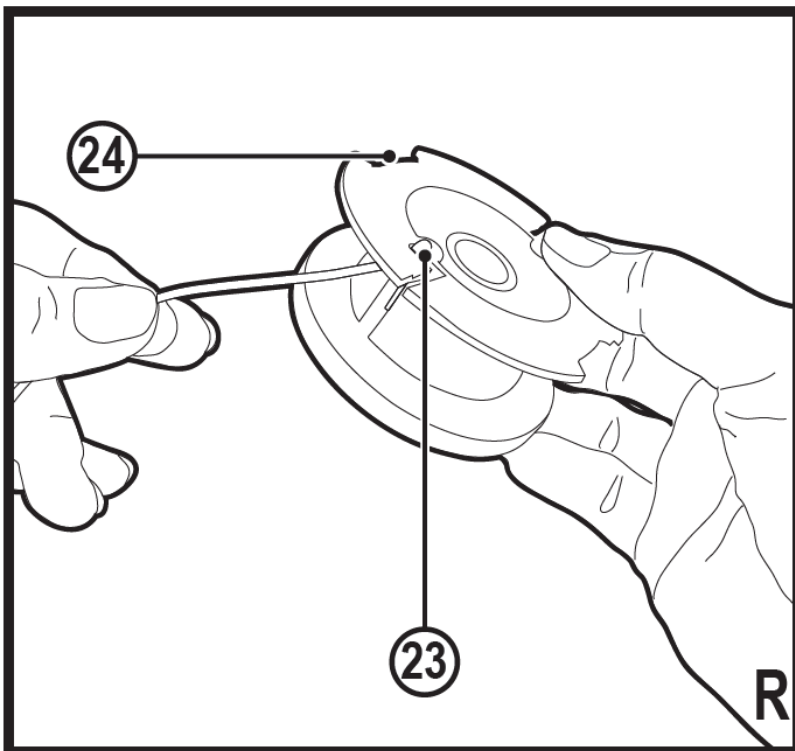

Insert the 19mm end of the bulk line into the hole (23) in the spool adjacent to the slot as shown in Fig. R.

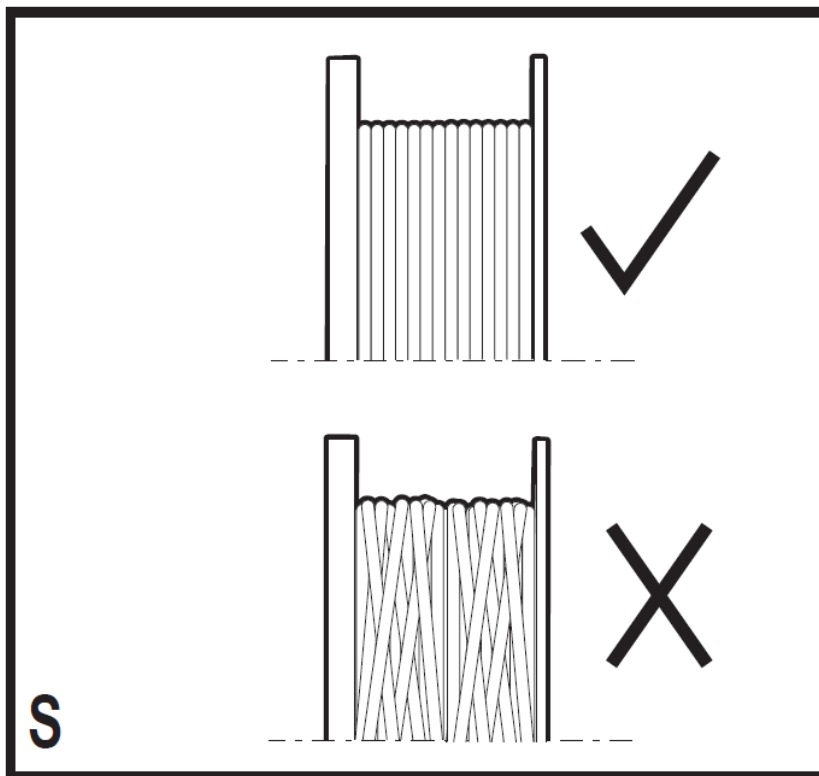

Make sure the line is pulled tight against the spool as shown in Fig. S.

Wind the cutting line onto the spool in the direction of the arrow on the spool.

Make sure to wind the line on neatly and in layers. Do not crisscross (Fig. S).

When the wound cutting line reaches the recesses (24), cut the line. (Fig. R).

Fit the spool onto the trimmer as described below.

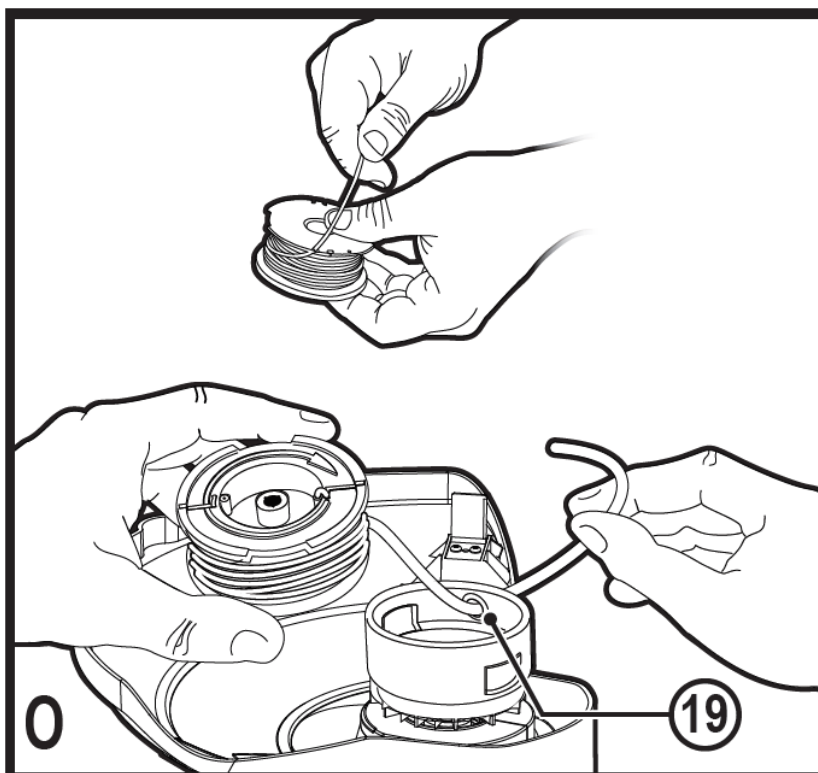

Guide the line into the eyelet (19) Fig. O.

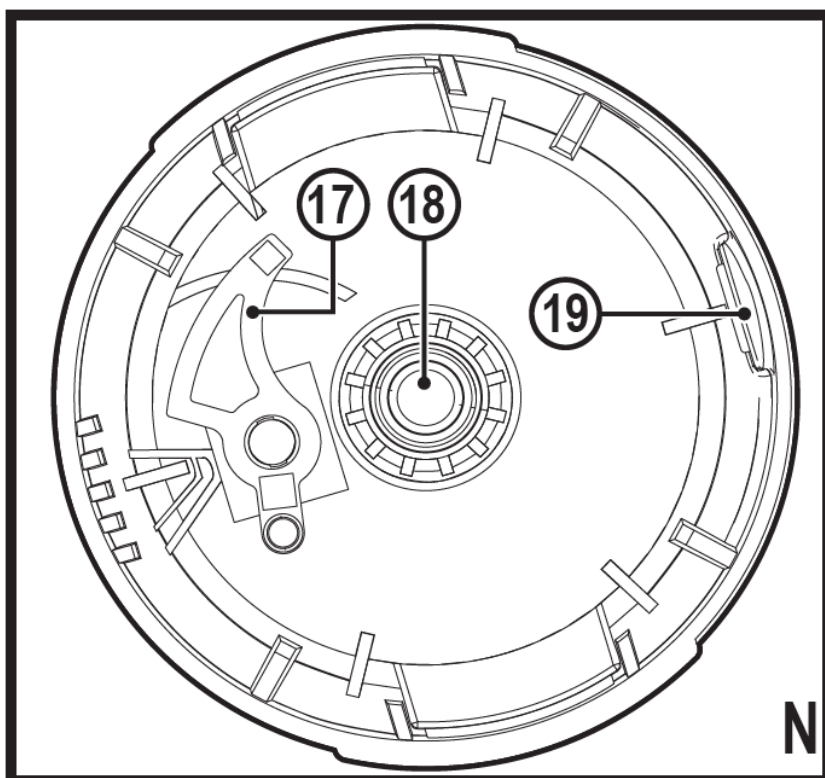

Take the new spool and push it onto the boss (18) in the housing (Fig. N). Rotate the spool slightly until it is seated. The line should protrude approximately 136mm from the housing.

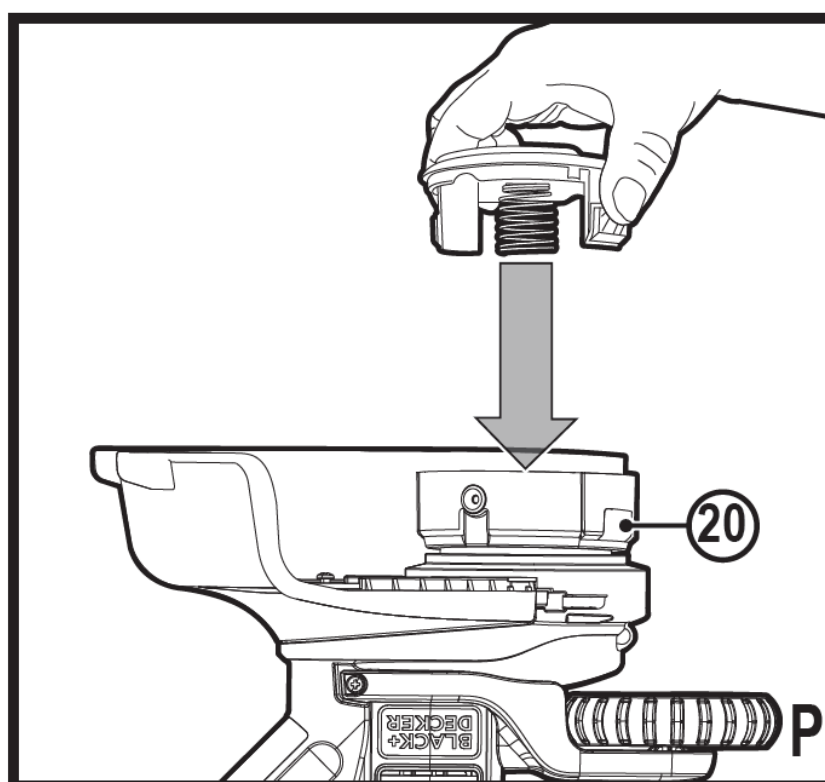

Align the tabs on the spool cap with the slots (20) in the housing (Fig. P).

Push the cap onto the housing until it snaps securely into place.