

Tecalemit

PART LIST

151111

HIGH SPEED LIFT

STANDARD & WHEELFREE

LIFT MODEL
122478/1 (415V 3pH)
123795/1 (240V 1pH)
138465/1 (415v 3Ph)(wide
138613/1 (240v 1Ph)(wide
139131 (415v 3Ph)(wide
140532 (240v 1Ph)(wide
150981/51 (415v 3Ph)
150982/51 (240v 1Ph)
151111/1 (415V 3pH)
151111/4 (hot climes)
151111/71 (415V 3pH)
151112/1 (240V 1pH)
151112/2 (220v 1 ph)
151112/71 (415V 3pH)
151194/4 (hot climes)
151196/71 (415v 3Ph)
151562/2 (220v 1Ph)
151996/1 (415V 3Ph)(wide
151999/1 (240v 1Ph)
151999/4 (hot climes)
151999/71 (240v 1Ph)(wide

Tecalemit Garage Equipment Co. Ltd.

Belliver Industrial Estate, Roborough, Plymouth, Devon, PL6 7BW.
Tel: Plymouth (0752)701212. Telex: 45124. Fax: (0752)796329.

... of Vehicle Servicing Equipment!



MAIN ASSEMBLY AND TRANSVERSE MEMBER

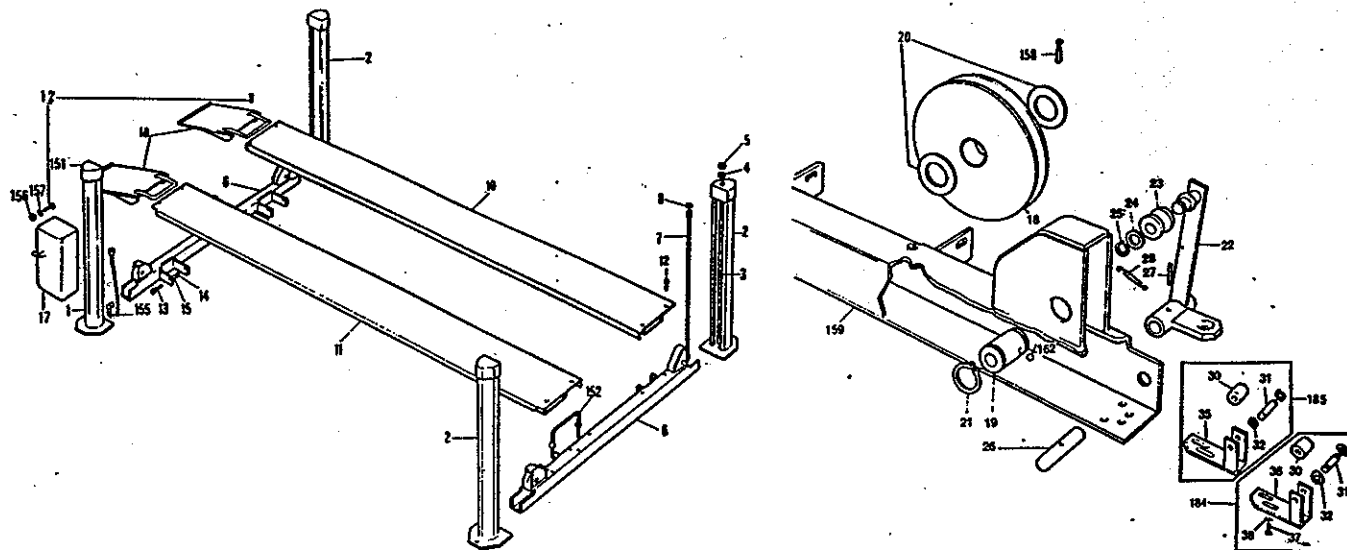

FIG 1

No	DESCRIPTION	PART No	No	DESCRIPTION	PART No
1	Corner Pillar S/A(non Block)	114663	21	Circlip	9042
1A	Mtr Pillar S/assy(Block)	114664	22	L.H.Lever Sub-Assy	XF 114721
2	Corner Pillar(non Block)	152317	23	Roller	XF 114691
2A	Corner Pillar(Block)	152318	24	Washer(was XF 1006)	21171 434
3	Safety Rod	XF 114727	25	Circlip	9018
4	Locknut(was 139/08)	21681 556	26	Safety Spindle R.H. Safety Lever	XF 114694
5	Nut(was 127/9)	21681 559	27	Spring Dowel(WAS 138/74)	21127 494
6	Transverse Member(Std)	121641	28	Spring(WAS XF 122126)	122126
7	Transverse Member(Wide)	138482	30	Stabilizer Roller	126787
7	Cable Set (Was SP11436)	114364	31	Stabilizer Pinwas XF 126788)	S 126788
8	Cable Set(Was SP138474)	138474	32	Circlip	140400 1
10	Locknut(was-139/11)	21681 555	33	Hinge R.H.(Std/Wide)	151060
10	L.H.Platform(Std)	151108	33	Hinge R.H.(Std/Wide/Flush)	148967
11	L.H.Platform(Wide)	135593	34	Hinge.L.H.(Std/Wide)	151061
11	R.H.Platform(Std)	151110	34	Hinge L.H.(Std/Wide/Flush)	148968
12	R.H.Platform(Wide)	135591	35	Stabilizer Brkt R.H.	XF 126791
13	Socket Screw	108681 2	36	Stabilizer Brky L.H.	XF 126792
14	Socket Screw	108681 1	37	Capscrew(WAS 158/2)	21615 22
15	Nut(was 146/5)	21485 37	38	Washer	1002
16	Washer(WAS 1006)	21171 434	151	Corner Cap	127136
16	Ramp(Std)	136626	152	End Stop(Std)	114783
16	Ramp(Wide)	147741	152	End Stop(Wide)	XF 135994
16	Ramp(Std Flush)	148962	152	Hose	121719 2
17	Ramp(Wide Flush)	149942	156	Nut(WAS 5006)	XF 5006
17	Power Pack 415v3P50Hz	139552 1	157	Lockwasher	1415
17	Power Pack 346v3P50Hz	139552 2	158	Rawl Plug Assy	152196
17	Power Pack 380v3P50Hz	139552 3	159	Transmission Member S/A(Std)	122719
17	Power Pack 220v3P50Hz	139552 4	159	Transmission Member S/A(wide)	138476
17	Power Pack 550v3P60Hz	139552 5	161	R.H.Safety Lever(Not Shown)	XF 114696
17	Power Pack 220v3P60Hz	139552 6	162	Ball	9812
17	Power Pack 240v1P50Hz	139553 1	174	Hydraulic Oil(5 ltr)	124081
17	Power Pack 220v1P50Hz	139553 2	184	Stabilizer L.H.S/Assy	126790
17	Power Pack 200v1P50Hz	139953 3	185	Stabilizer R.H.S/Assy	126789
18	Single Pulley Assy	125917	-	Safety Rail Kit(D/On-Back/Off)	151063
19	Pulley Pin	XF 114602	-	Safety Rail Kit(D/Thru)	151062
20	Thrust Washer	121949			

LIFT CONTROL VALVE 135857 SPARES KIT SP152362

ITEM	DESCRIPTION		
92	Cam	122351	
93	Spring Dowel	138	69
94	Spindle	XF 135786	
95	Seal	134	16
96	Lever	XF 149925	
97	Knob	149924	
98	Dowel	176	51
99	Ball (Spares Kit SP152362)	XXX	
100	Spindle	122353	
101	Seal(spares Kit 134/4)	XXX	
102	Spring	122356	
103	Seal(Spares Kit SP152362)	XXX	
104	Adaptor(Spares Kit SP152362)	XF 122951	
105	Spindle	122354	
106	Valve Seat	XXX	
107	Ball (Spares Kit SP152362)	XXX	
108	Spring	122357	
109	Taper Plug	133	3
110	Micro Switch	122397	
111	Cover	122398	
112	Screw	102	16
113	Housing	AO 127866	
114	Gasket(Spares Kit Sp 152362)	XXX	
115	Setscrew	120	49
116	Body	AO 127867	

PARTS REFERENCE FIG 2

CONTROL VALVE
135857

SPARES KIT
SP 152362

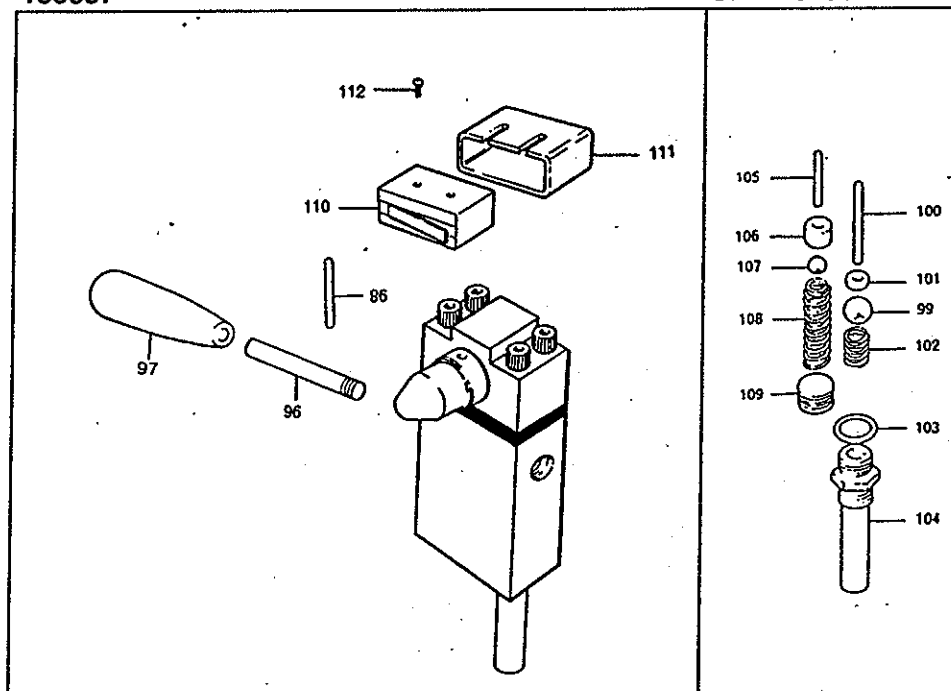

FIG 2

RAM HOUSING PLATFORM 151110

ITEM	DESCRIPTION	PART NUMBER
No		
118	Roller(see also SP150416)	149893
119	Pin(See also(SP150416) 2-1141/51	84131
120	Safety Bracket(See Also SP150416)	Z 149892
121	Screw(See also SP150416)	208 65??
122	Bracket(See also(SP150416)	138491
123	Setscrew(was 182/07)	21631 124
124	Nut,(was 127/1)	21681 543
125	Lockwasher M5	1401
126	Locking Wire	138489
127	Coupling	121950
128	Seal Lead Type)	138490
129	Bonded Seal	98175 3
130	Safety Valve Assy	138467
131	Strap	114762
132	Pipe	138479
133	Pipe Clip(was 73985)	152413
134	Setscrew(was 182/08)	21631 124
135	Spacer	74088 1
136	Pulley,Single	125917
136a	Bearing,Single Pulley.1"	121847
137	Pulley Pin	XF 114603
138	Pulley,Double	121918
138a	Bearing,Double Pulley. 1 3/4"	XF 121848
139	Thrust Washer	121949
140	Circlip	9042 ???
141	Guide	XF 122150
142	Setscrew(was 129/01)	21661 701
143	Setscrew(was 129/34)	21661 724
144	Nut(was 127/03)	21681 545
145	Lockwasher	1403 ???
146	Ram Assy	139014
147	Nut(was 137/10)	21683 105
149	Nut(see Also Sp150416)(was 137/09)	21683 103
150	End Plate(see Also Sp150416)	Z 149891
171	Spacer	XF 122052
172	Spacer	XF 122053
173	Platform.R.H.(Welded Sub-Assy)	EA 151109
177	Coupling	122172
178	Warning Label	126458
179	Screw	3913 ???
180	Lockwasher	1110 ???
181	Nut	5903 ???
187	Splitpin(was 6015 was G114??)	6015 ???
188	Splitpin	6042 ???
189	Splitpin	6049 ???
190	Parking Device(Std 2 Prong)(was XF122446)	SP 122446
190a	Parking Device(No Chain Req'd)Wider 3 Prong)	XF 149798
-	Hydraulic Oil For Ram	124081
-	Ram Seal Kit	149834

Note: Item 173 Part Number 135592 for Wider Version

NEW RAM SEAL KIT SABRE P/P 555-737011

RIGHT HAND PLATFORM 151110
(Ram Housing Platform)

RIGHT HAND PLATFORM
(Ram Housing Platform).

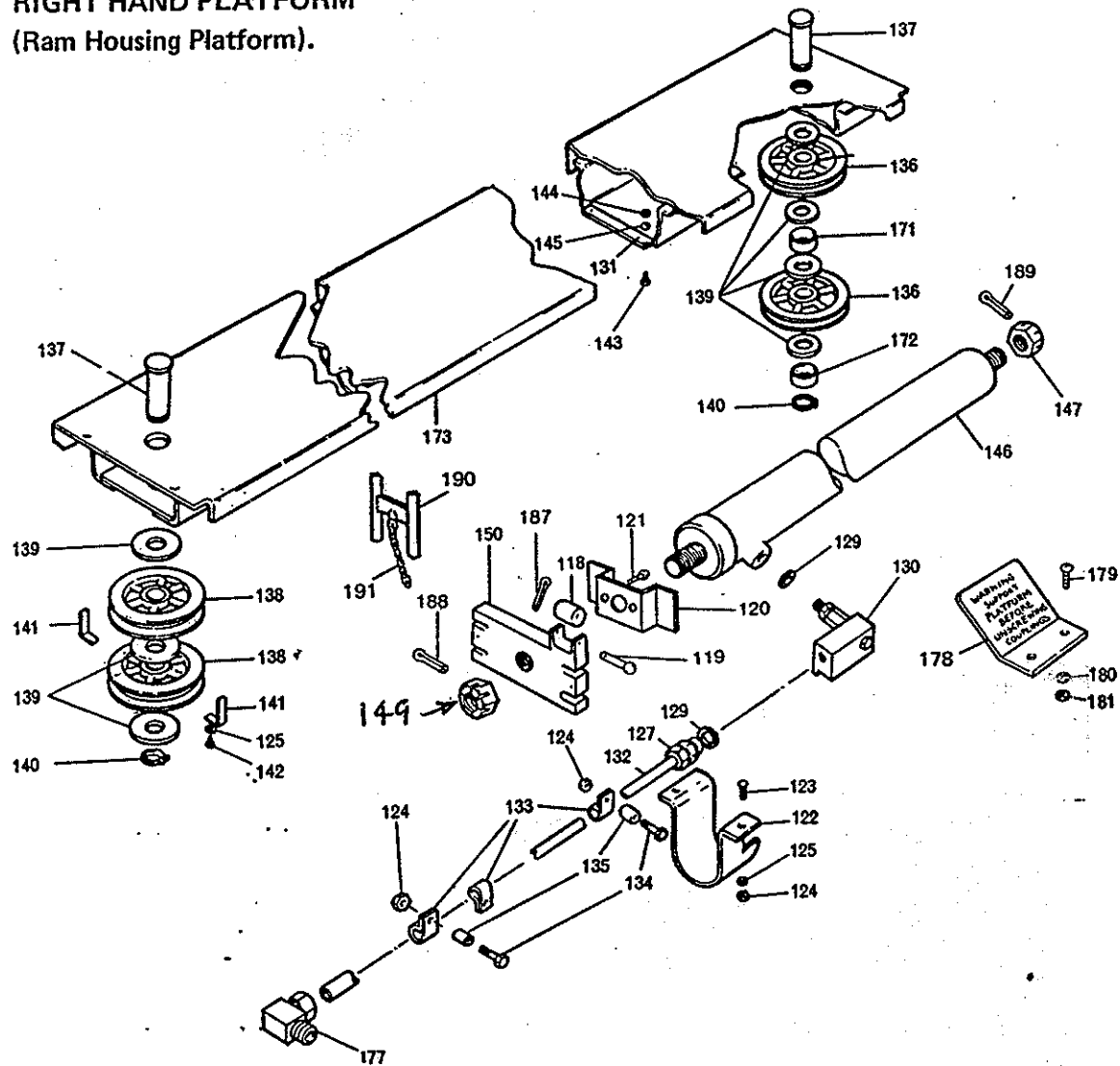

M24 (147) - 21885-821
M30 149 - 21883 615 } NEW MIPRO

FIG 3

POWER PACK ASSEMBLY

3 Phase Model 139552/1

1 Phase Model 139553/1

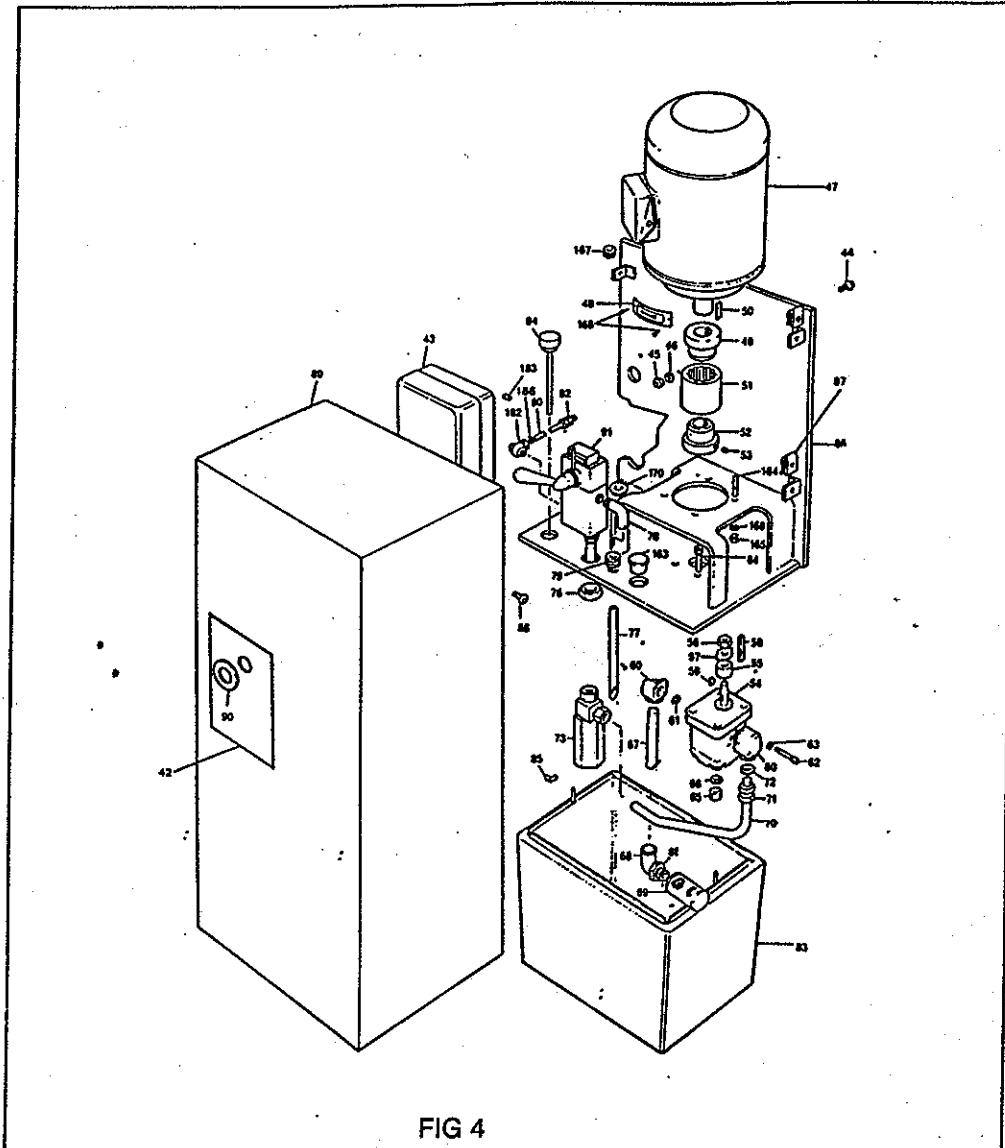

FIG 4

PUMPS-STARTERS & MOTORS(see Power Pack)

ITEMS43/47/54

LIFT MODEL	PUMP	STARTER	MOTOR
122478/1 (415V 3pH)	135469	280 7	122147 1
123795/1 (240V 1pH)	135470	280 28	124512 1
138465/1 (415v 3Ph)(wide	135469	280 7	122147 1
138613/1 (240v 1Ph)(wide	135470	280 32	150637 3
139131 (415v 3Ph)(wide	135469	280 7	122147 1
140532 (240v 1Ph)(wide	135470	280 28	124512 1
150981/51 (415v 3Ph)	135470	280 28	122147 1
150982/51 (240v 1Ph)	135470	280 32	150637 3
151111/1 (415V 3pH)	135469	280 7	122147 1
151111/4 (hot climes)	135470	280 13	122147 1
151111/71 (415V 3pH)	135469	280 7	122147 1
151112/1 (240V 1pH)	135470	280 28	124512 1
151112/2 (220v 1 ph)	135470	280 4	124512 2
151112/71 (415V 3pH)	135470	280 28	122147 1
151194/4 (hot climes)	135470	280 32	150637 3
151196/71 (415v 3Ph)	135469	280 7	122147 1
151562/2 (220v 1Ph)	135470	280 4	124512 2
151996/1 (415V 3Ph)(wide	135469	280 7	122147 1
151999/1 (240v 1Ph)	135470	280 28	124512 2
151999/4 (hot climes)	135470	280 32	150637 3
151999/71 (240v 1Ph)(wide	135470	280 28	124512 1

POWER PACK..3Ph 139552/1 1Ph 139553/1

42	Control Label		151326	
44	Screw		3962	???
45	Nut		5903	???
46	Washer		1001	???
48	Direction Plate		70206	
49	Coupling(WAS 122051)		23315	462
50	Key		235	2
51	Sleeve		122233	
52	Coupling(WAS 122050)		23315	462
53	Grubscrew(WAS 153/21)		21813	66
55	Adaptor		XF 122049	
56	Nut		139	1
57	Tab Washer		65300	
58	Key		8120	???
59	Key		8320	???
60	Adaptor(was 122245)) 23345/161		
61	Seal (was XF1220149)) Now	23345	161
62	Capscrew (was 172/06)) 23345/141		
63	Lockwasher (was 1401))		
64	Capscrew		158	4
65	Nut		127	1
66	Lockwasher		1401	???
67	Pipe		122398	
68	Elbow		35257	5
69	Filter		122241	
70	Pipe		122979	
71	Coupling		121950	
72	Bonded Seal		98175	1
73	Relief Valve		122244	1
76	Backnut		26012	1
77	Pipe		122973	
78	Elbow		35257	5
79	Grommet		9398	13
80	Pipe		123193	
81	Bush		74943	1
82	Coupling		126166	
83	Tank		139444	
84	Dipstick		XF 139554	
85	Wingnut		214	6
87	Captive Nut		122950	2
88	Screw		161	4
89	Cover		139443	
90	Disc		122909	
91	Lift Control Valve		135857	
163	Cap		207	22
164	Stud		XF 122256	
165	Nut		166	4
166	Washer		1402	???
167	Grommet		9388	13
168	Drive Pin		9910	
170	plug		122985	
182	Coupling		126167	
183	Taper Plug		133	1
186	Filter		149833	

WHEEL FREE SYSTEM

WHEEL FREE UNIT 139651

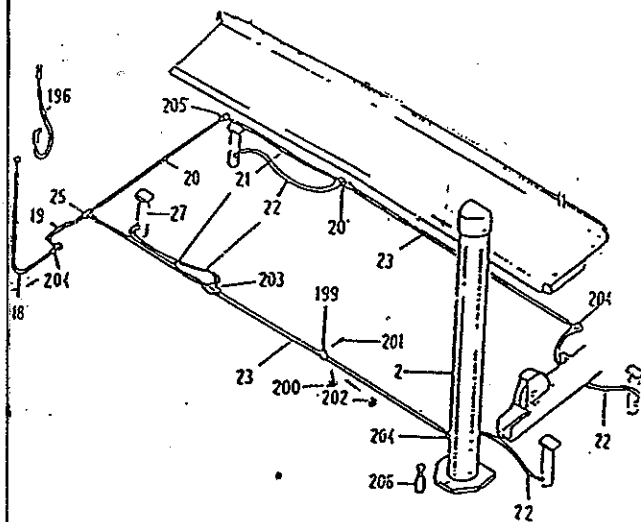

FIG 5

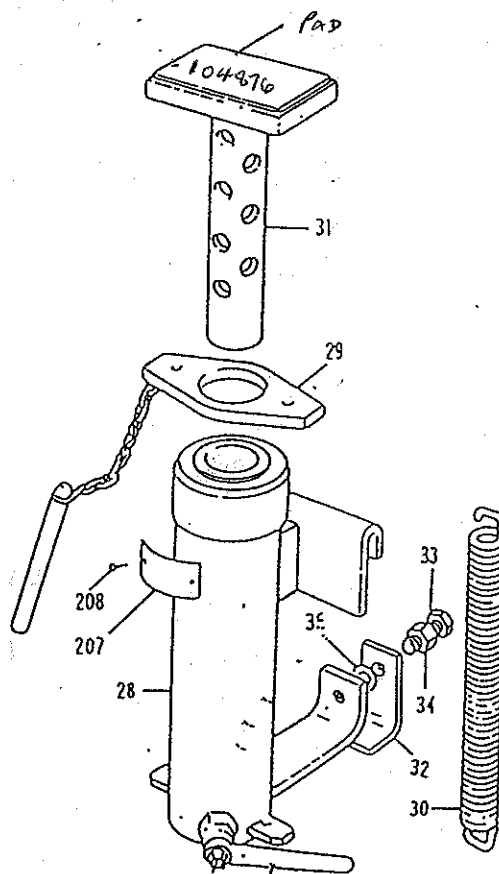
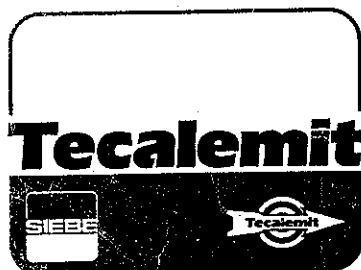

FIG 6

No	DESCRIPTION	PART No	No	DESCRIPTION	PART No
22	Hose	SH 123048	199	Pipe Clip	73985 3
23	Pipe	122807	200	Spacer	74088 4
25	Coupling	122977	201	Setscrew	182 8
27	Wheel Free Unit)	139651	202	Nut(WAS 127/1)	21681 543
29	Plate Assy	XG 123123	203	Coupling	123047
30	Spring	XF 135412	204	Coupling	123011
31	Lifting Member S/Assy	123209	205	Coupling	122171
32	Bracket	XG 125110	207	Namplate	136060
33	Setscrew	129 36	208	Screw	9901
34	Nut	21681/543 127 5	209	Lever	149664
35	Lockwasher	1120	230	Lever & Valve Assy	139657
-	Seal Kit	127049			

PARTS REFERENCE FIG 5 & 6

**Tecalemit Garage Equipment Co. Ltd,**Belliver Industrial Estate, Roborough, Plymouth, Devon, PL6 7BW.
Tel: Plymouth (0752) 701 212. Telex 45124. Fax: (0752) 796 329*The complete range of Vehicle Servicing Equipment!*

Manufactured and marketed by Tecalemit Garage Equipment Co. Ltd.